

HUTKIN FOR LEASE

DEVELOPMENT COMPANY *Office / Warehouse*

1849-1897 Craig Road
Maryland Heights, MO 63146



- 6,222 - 12,790 Square Feet Available
- **1871 Craig Road - 6,222 SF** — **1873 Craig Road - 6,568 SF**
 - 30% office finish — 30% office finish
 - 1 dock high door — 1 drive-in door
 - **\$5.75 psf, Modified Gross** — **\$6.25 psf, Modified Gross**
- 1871 & 1873 can be combined to create 12,790 square feet*
- **1865 Craig Road - 9,415 SF**
 - 14% office finish
 - 1 dock high door
 - **\$5.25 psf, Modified Gross**
- Located just south of Page Avenue on Craig Road
- 17' warehouse ceilings

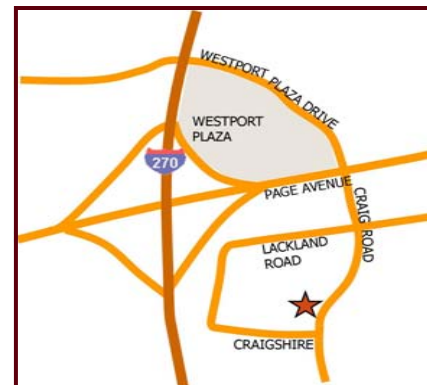

HUTKIN DEVELOPMENT COMPANY
10829 Olive Boulevard
Suite 200
St. Louis, MO 63141
Telephone 314.872.9140
FAX 314.872.9001
Visit our website:
www.hutkin.com

CONTACT

Ryan Carlie
rcarlie@hutkin.com
Cell 314.496.4887
Brad Eisel
beisel@hutkin.com
Cell 314.800.6654

See site plan and floor plans on reverse

HUTKIN FOR LEASE

DEVELOPMENT COMPANY *Office / Warehouse*

1849-1897 Craig Road
Maryland Heights, MO 63146

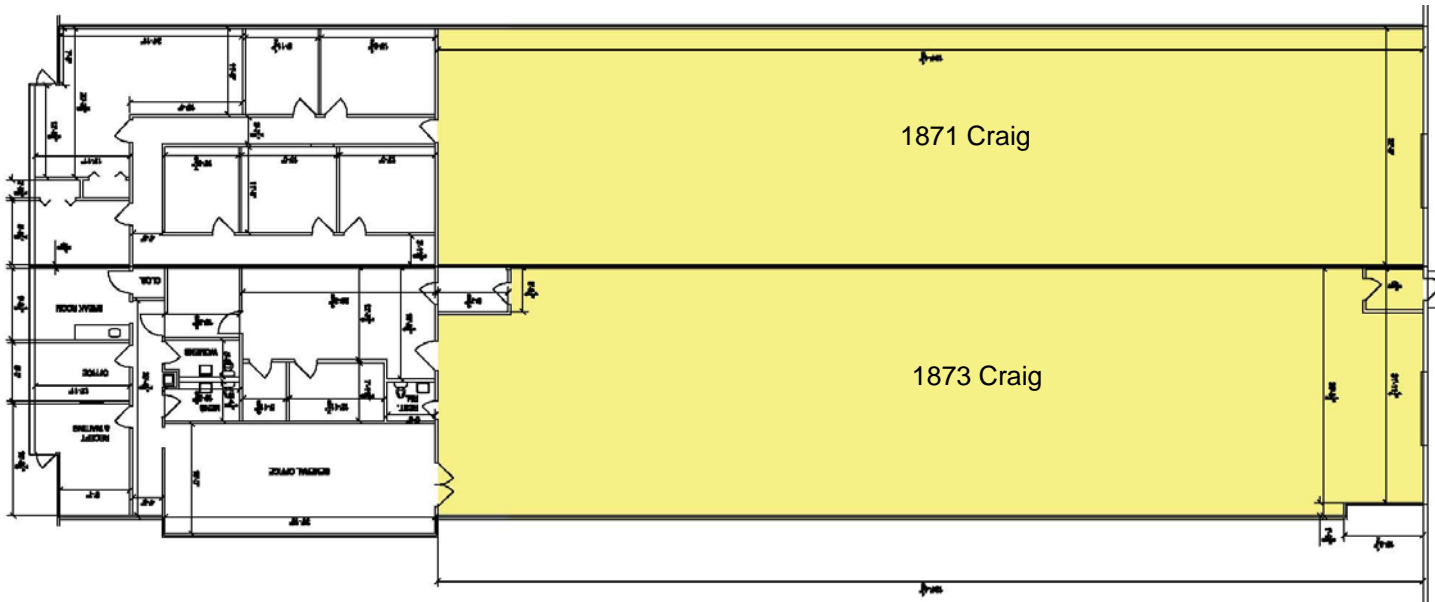
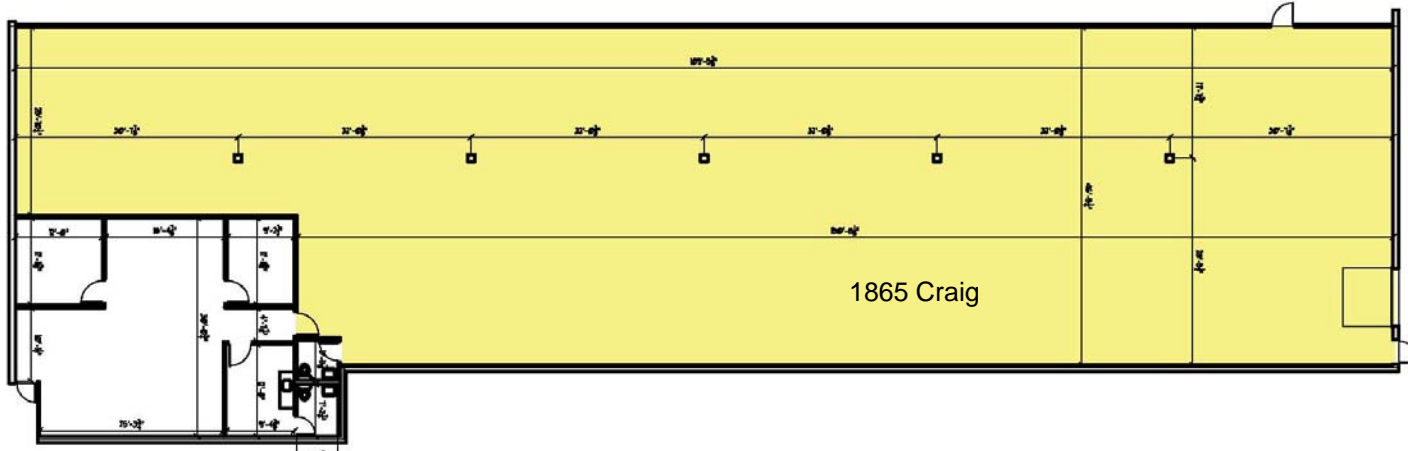

Warehouse Space

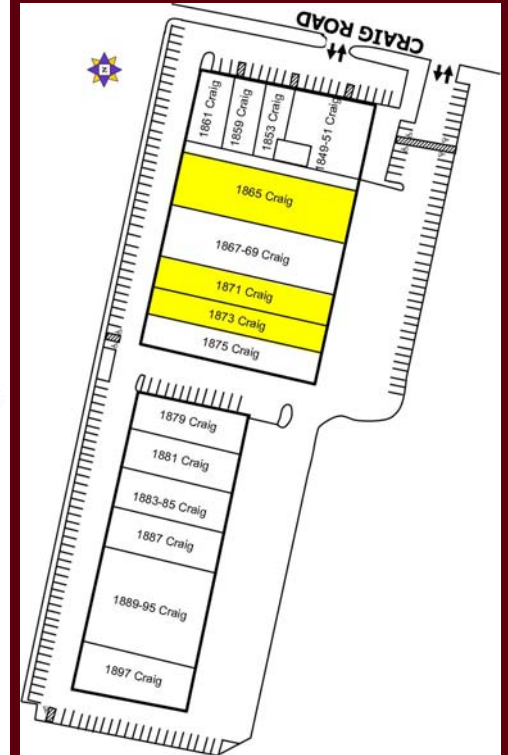

HUTKIN DEVELOPMENT COMPANY
10829 Olive Boulevard
Suite 200
St. Louis, MO 63141

Telephone 314.872.9140
FAX 314.872.9001

Visit our website:
www.hutkin.com